

# ALTOPLUS QUICK START GUIDE

## Basic Installation

- Step 1:** Install the backup batteries (optional) by removing the battery cover as shown in *Figure 1*.
- Step 2:** Pull the ends of the phone cord to untangle the cord; connect the loose end of the phone cord into your wall telephone outlet.
- Step 3:** Place handset in cradle.
- Step 4:** Pull the ends of the power cord apart to untangle the cord; plug the adapter into your wall's electrical outlet.
- IMPORTANT:** Use only with Class (Classe) 2 power source, provided with your product.
- Step 5:** When finished, lift handset to test. If you hear a dial tone, your telephone is ready for use. If not, check all connections again.

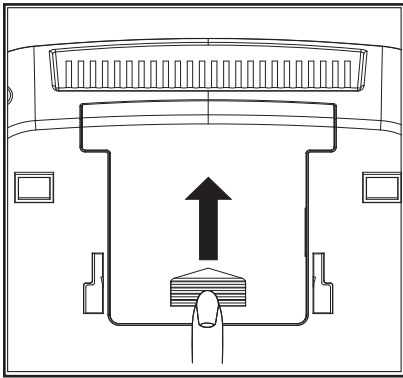

*Figure 1*

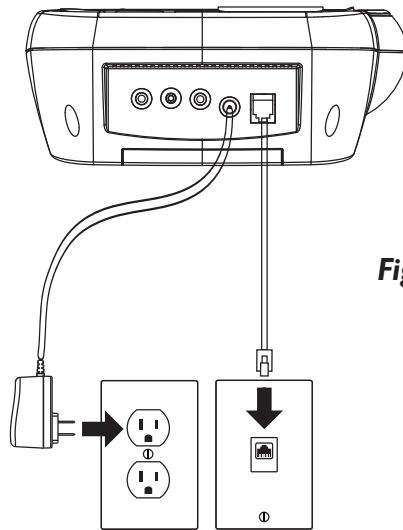

*Figure 2*

If there is a power outage, the AltoPlus will maintain its full amplification for up to 48 hours with four AA alkaline backup batteries (not included).

The phone operates as a regular phone if there is no power or backup batteries. In this case, the indicator lights, the loud ringer, the lighted keypad and the amplification will be disabled; you will still be able to make and receive phone calls, but the extra amplification will not be engaged.

We recommend installing batteries if you live in an area with frequent power outages.

# ALTOPLUS QUICK START GUIDE

## Wall Mount Installation

- Step 1:** Pull the handset hook out of the base and reverse its position so that the hook points up and will hold the handset when you hang up. (See *Figure 1*)
- Step 2:** Pull the ends of the phone cord to untangle the cord; run the cord through the groove on the back of the phone. Insert the tabs of the mounting bracket into the slots in the back of the phone. Push the mounting bracket in and down firmly until it snaps into place. (See *Figure 2*)
- Step 3:** Plug the flat telephone line cord into the wall plate jack, then align the mounting bracket's keyhole slots with the wall plate studs and slide the base of the phone downward to secure it on the wall. (See *Figure 3*)

*Figure 1*

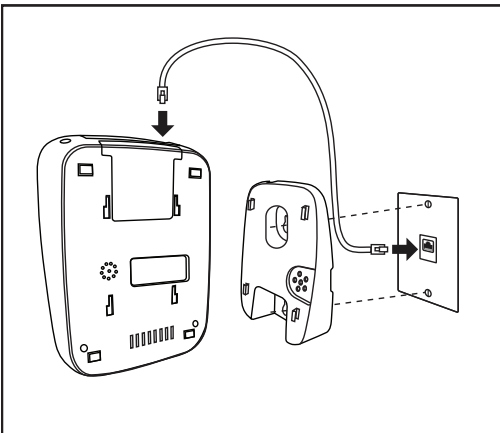
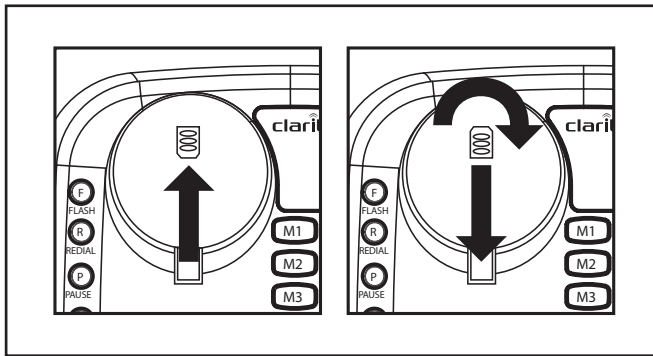

*Figure 2*

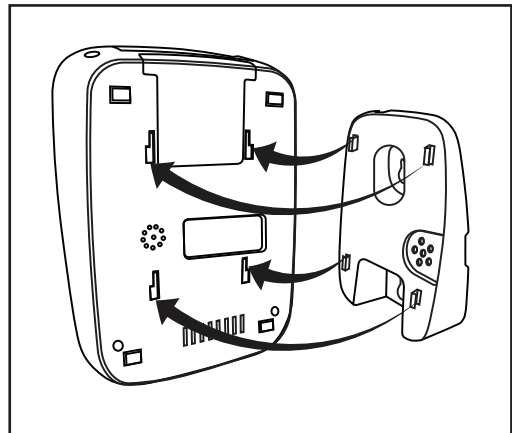

*Figure 3*